



A brand of **legrand**

# Ducted Ceiling Exhaust Fan

EFD01RDWE, EFD01RDMS, EFD01SQWE

Up to Max Air Flow 330m<sup>3</sup>/h  
Easy Plug-in  
3 years Warranty







Our HPM Ducted Ceiling Exhaust Fan is ideal for bathrooms, kitchens and laundries. While it whisks away steam and odours, it also prevents the build up of mould, mildew and fogging mirrors.



## SPECIFICATIONS



Cat No.	EFD01RDWE	EFD01RDMS	EFD01SQWE
Description	Round Ceiling Exhaust Fan		Square Ceiling Exhaust Fan
Colour	White (WE)	Matte Silver (MS)	White (WE)
Supply voltage	230 - 240V a.c. 50Hz		
Exhaust fan	Centrifugal		
Maximum airflow	330m <sup>3</sup> /h*		
Motor rating	40W Max.		
IP rating	IPX4		
Decibel rating at 3m	36dBA**		
Fascia size	Ø372mm	350 x 350mm	
Fascia protrusion	26mm		
Projection into ceiling	190mm		
Cut-out size	Ø298mm		
Weight excl. packaging	2.3kg	2.35kg	
Power cord length	70cm		
Warranty	3 years		

\* Airflow dependent on installation conditions. Airflow measured at 250mm<sup>3</sup>/h with Ø150mm duct 3m long  
 \*\* Tested in accordance with AS 1217.5: 1985 Acoustics - Determination of sound power, levels of sources: free field over a reflecting plane (floor)

## HIGH PERFORMANCE

The exceptional airflow performance provided by the centrifugal fan design ensures quick removal of steam and odours, while remaining quiet.

The EFD01RDWE provides an exceptional 250m<sup>3</sup>/h when 3 metres of ducting is connected.

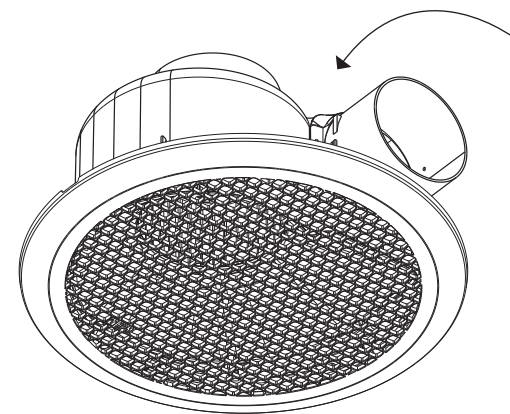

HIGH PERFORMING CENTRIFUGAL FAN WITH MINIMAL NOISE

**!** The built-in draft shutter is a requirement of the Australian Building Code; it helps to prevent the entry of insects into the room. This flap opens when the fan is running and closes to prevent back drafts when the fan stops.

## PLACEMENT

With our high level of protection of IPX4, it is possible to place your Exhaust fan closer to your shower and helps avoid extreme fog in the bathroom, especially on mirrors. Our EFD01 Range can all be installed in the ceiling above Zone 1 due to their IP Rating IPX4.



For safety reasons, there are a few rules to follow when installing an exhaust fan close to a shower:

It is necessary to respect zones of installations

- Zone 0:** This is the interior of the bath tub or shower basin
- Zone 1:** This extends above Zone 0 and around the perimeter of the bath or shower basin to 2.25m for NZ and 2.5m for Australia above the floor level
- Zone 2:** This extends 600mm beyond Zone 1 and to a height of 2.25m for NZ and 2.5m for Australia above floor level

Where possible we recommended your fan is not installed directly above the shower/bath as condensation may occur causing dripping  
 Note: Example shown is typical only. Consult AS/ NZS 3000 for full definition of installation zones in wet areas.

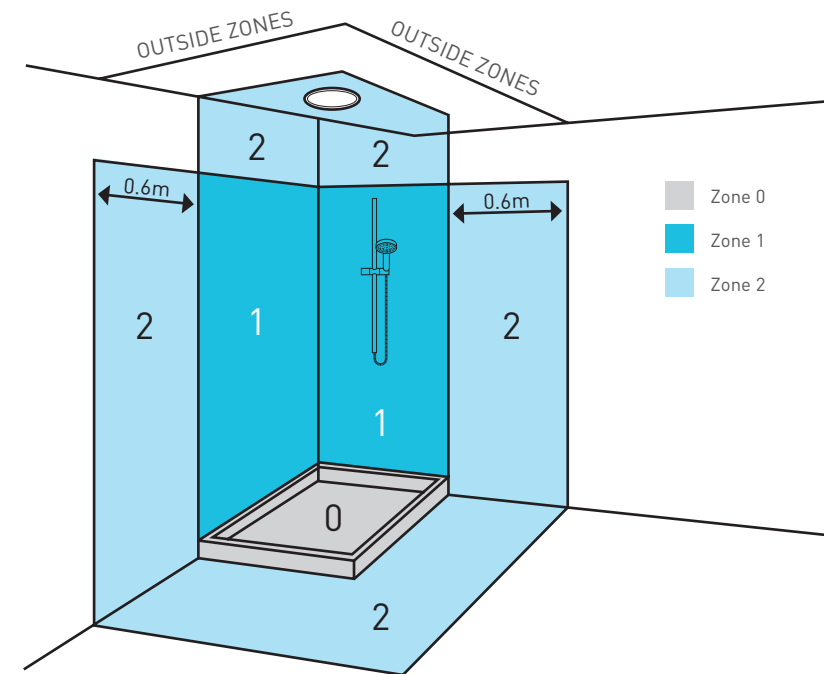

For optimum performance the exhaust fan should be vented /ducted horizontally to an eave AND must have an open window or 20mm gap between base of door and the floor to allow cross ventilation.

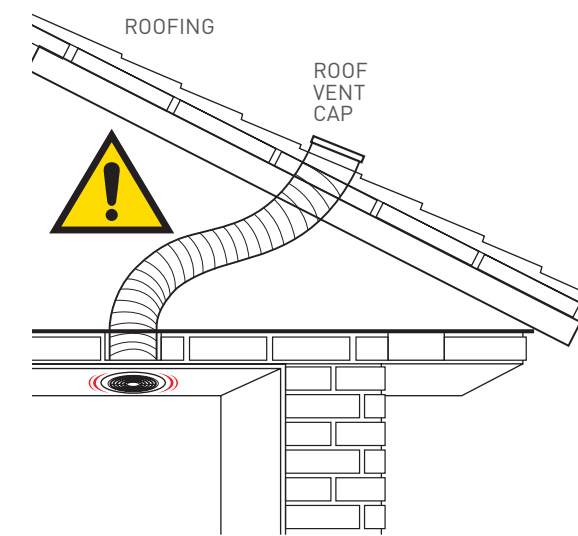
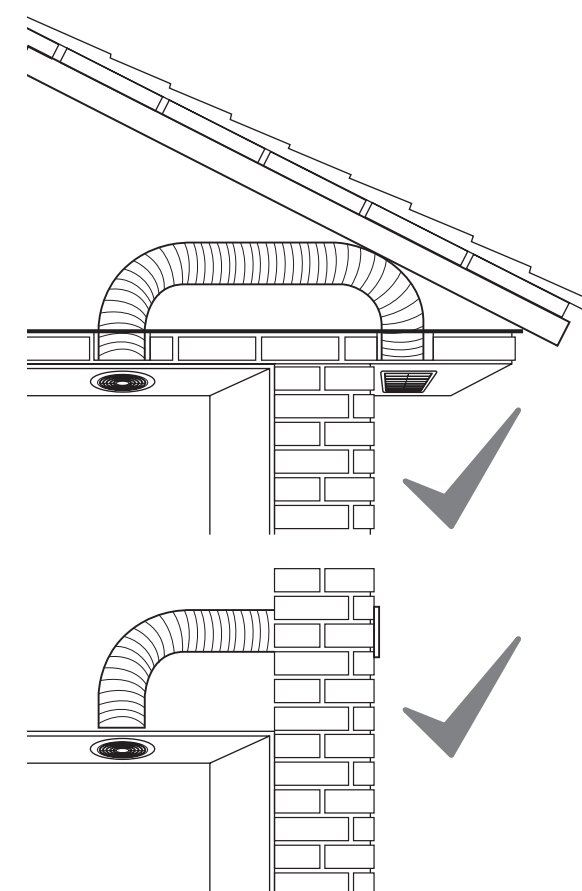

**!** Vertical installation of the ducting may reduce fan performance, increase noise level and cause condensation/dripping.

## EASY INSTALLATION

- Determine position in ceiling where the exhaust fan is required to be installed
- Use the template provided to draw a circle. To do this, insert a thumb tack at one end and insert a pencil at the other end and scribe a circle.
- Cut out around this line. Remove grille from the exhaust fan.
- Attach 150mm duct adaptor to duct with duct tape (if 100mm duct is used it will decrease air movement).
- Ensure that a power outlet is installed in the ceiling near the intended position of the exhaust fan. Ensure that power to the outlet is off. Plug the exhaust fan into this outlet.
- Attach duct adaptor to the exhaust fan outlet.
- Insert the unit into the cavity.
- With the unit in place, turn the toggles (4x) clockwise and tighten the screws until the clamps securely grip the ceiling.
- Push grille onto unit and click into position.





A brand of **legrand**<sup>®</sup>

Legrand Australia  
Building 4, Nexus Industry Park  
43-47 Lyn Pde  
Prestons NSW 2170  
1300 369 777  
[www.hpm.com.au](http://www.hpm.com.au)

Legrand New Zealand  
106-124 Target Road  
Glenfield Auckland 0627  
0800 476 009  
[www.hpm.co.nz](http://www.hpm.co.nz)

Disclaimer: The information provided in this document is intended for informational purposes only has been prepared and reviewed with all reasonable care, believed to be correct at the time of printing. Legrand Australia and New Zealand may also make improvements and/or changes in the products, pricing and/or programs described in this information at any time without notice.