

ELIOT CONNECTED DOORBELL + CHIME KIT



094232
D642ELIOTKIT



Specifications:

- WiFi 2.4 GHz - IEEE 802.11 b/g/n
- Android / iOS compatible
- Power supply: 3 x AA batteries (not included) – do not use rechargeable batteries
- Camera angle: 95°
- Also compatible with HPM Kit cat no. D642/L1
- Must be connected to WIFI
- Wireless pushbutton: IP44 – IK 06
- This product is rated IP44 and can be used outside. Install it sheltered from direct sunlight and rain (under a porch or roof overhang)
- Wide-angle camera with built-in LEDs for night photography
- Battery life ≈ 1500 calls
- The WiFi and photography are activated only by a push
- 30-day dated photo history
- Wide choice of ringtones in the app

How to set up your ELIOT Connected Doorbell to your device:

1



- Scan the QR code to download the application in Apple Store or Google Play



- The name of the App is Legrand Doorbell



- Tutorial Video

2



- Create an account (this account can be used on several smartphones to link them to the same doorbell)

3



- Insert the 3xAA batteries. When LED on the front of the doorbell is blinking in red, that means the batteries are low and need to be changed.

4



- Your device must be connected to the local Wi-Fi network.
- Enter the local Wi-Fi password

5



- Press + hold reset button in the BACK while pushing once on the button in FRONT. Release reset button after 5 sec. The LED starts to blink.
- Click Next on your smartphone to pair it

094232
D642ELIOTKIT

6

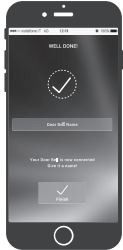

• The bell is connected to the network. Give it a name

7



• Congratulations! You have successfully set up your device to the ELIOT Connected Doorbell.

Sync your RECEIVER to your DOORBELL

Speaker receiver

In order for you to receive the picture of the person at your door to your device, push the ELIOT Connected Doorbell.

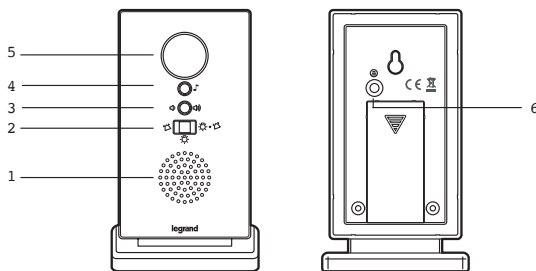

- 1. Speaker
- 2. Call signal selection (acoustic, illuminated, acoustic + illuminated)
- 3. Volume setting (low, medium, high)
- 4. Melody selection (36 polyphonic melodies available)
- 5. Indicator light
- 6. 'Synchronise with transmitter' button

- Range: up to 100 m free field
- Power supply: 2 x 1.5-V AA batteries (not supplied)
- Radio frequency: 433 MHz

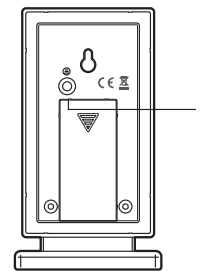

- To pair a transmitter with a receiver, press the synchronisation button (see No. 6) on the receiver at the same time as the push-button on the transmitter you want to link with it.

Applications

- Wall-mounted

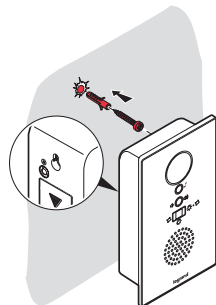

- On base

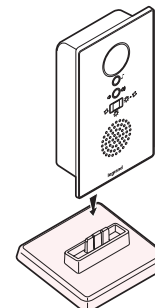

Warranty

Legrand will honour all statutory guarantees that you as a consumer are entitled to rely upon under the Australian and New Zealand Consumer Laws against a manufacturer including a guarantee that any products Legrand has manufactured or imported are of acceptable quality.

To make a claim under any statutory guarantee (or other warranty) you should first contact the supplier, contractor or retailer from whom you purchased the products.

Customer Service

For all Customer Service and Technical Support enquires please call Monday to Friday during business hours.

Legrand Australia Legrand New Zealand
1300 369 777 0800 476 009
www.legrand.com.au www.legrand.co.nz

ABN: 31 000 102 661