

Hey Siri,  
turn on the light

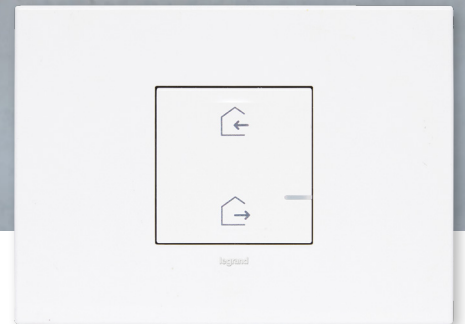
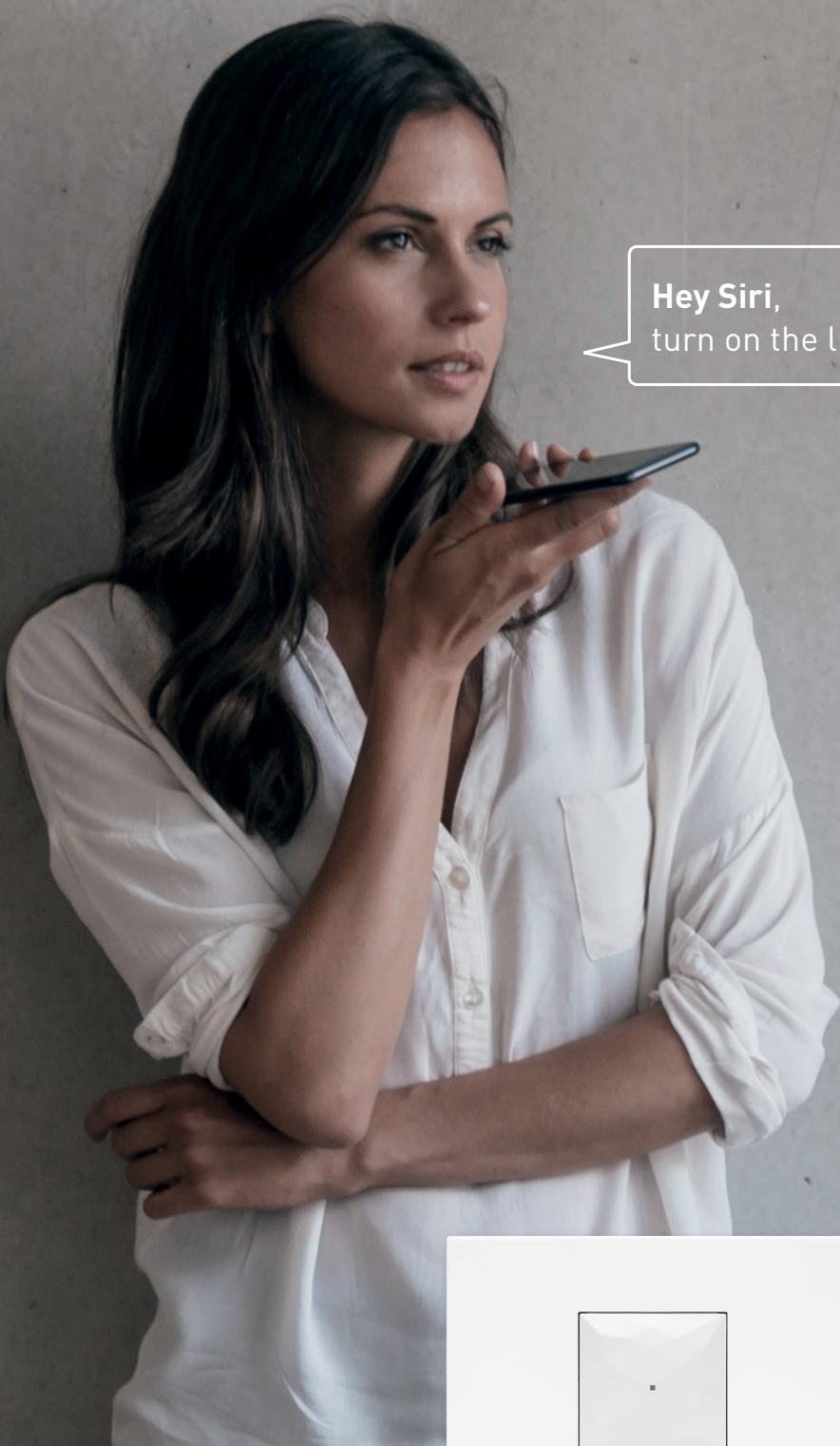

CONFIGURATION  
MANUAL

# Arteor™

with NETATMO

**SMART HOME MADE EASY**

YOU'RE ONLY A FEW STEPS AWAY FROM TURNING YOUR NEW HOME INTO A SMART HOME!

WE'VE FITTED YOUR HOME WITH ARTEOR WITH NETATMO SMART SWITCHES AND SOCKETS.



Product wiring and install



Pre-configuration



Add to Wifi network



Assign products to rooms



Voice assistant configuration (not covered in this document)

The products have been pre-configured for you, but a few more steps are necessary to complete your Smart Home installation.

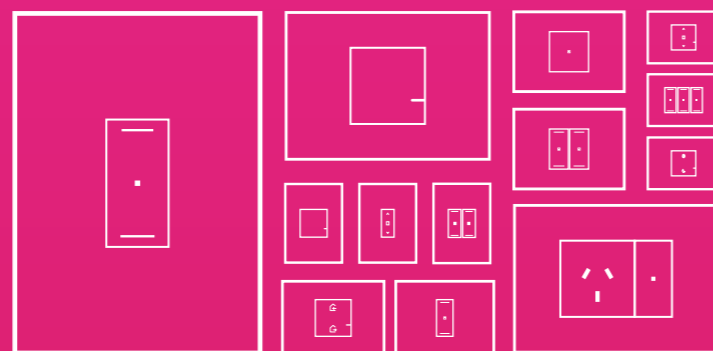

To setup Arteor with Netatmo, a Wi-Fi network and internet connection is required. For privacy and security reasons, we recommend keeping your Wi-Fi Network details private. A few easy steps described in the following pages, will guide you through this easy process.



Should you have further questions, please ring Legrand on 1300 369 77 (Monday-Friday 8am to 5pm AEST) and we would be happy to talk you through these steps.



## Contents



Download the Home + Control App



Create an account



Set up the installation



Change the location of products room by room



Share your installation with others

# LET'S GET STARTED

## 1 DOWNLOAD THE HOME + CONTROL APP

- Requirements:
- Active internet connection
  - WiFi modem
  - Smartphone or tablet



FREE DOWNLOAD

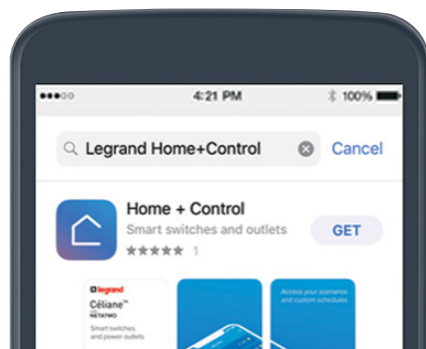

2. Search "Legrand Home+Control".

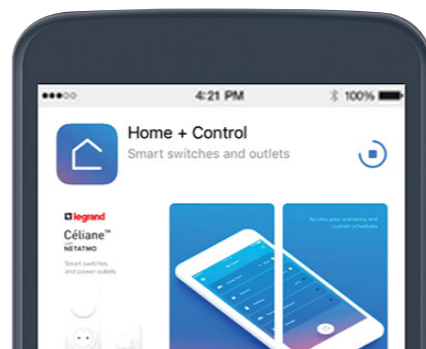

3. Download the app.

1. Go to **App store** or **Google Play store**.

## 2 CREATE AN ACCOUNT (continued)

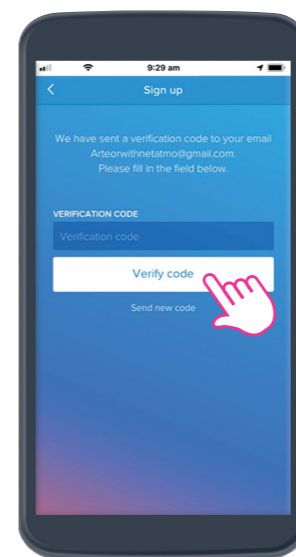

5. Go back to the **Home+Control app**, enter the verification code and click "Verify".

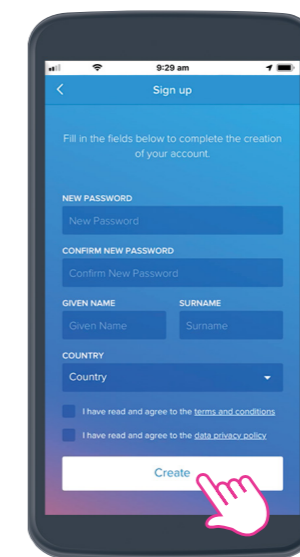

6. Fill in details required and click "Create".

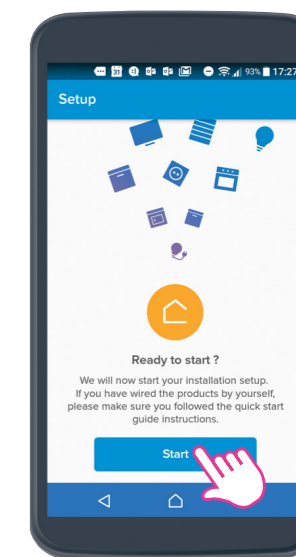

7. Click "Start".

## 2 CREATE AN ACCOUNT

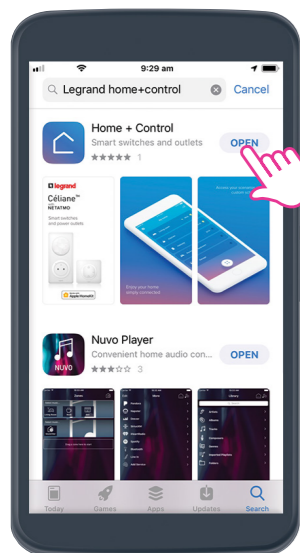

1. Launch the **Home+Control app**.

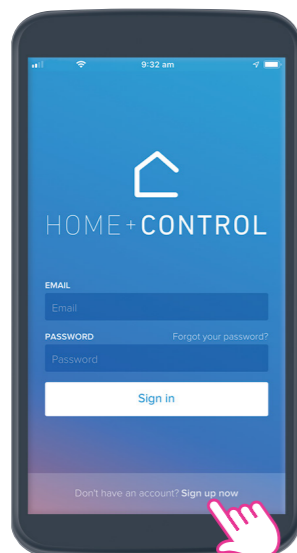

2. Click on "Sign up now" at the bottom of the screen.

Note: if you already own a Legrand ELIOT doorbell or Bticino Classe300 Wifi intercom, skip this step. Enter the same credentials as used in the app for those products.

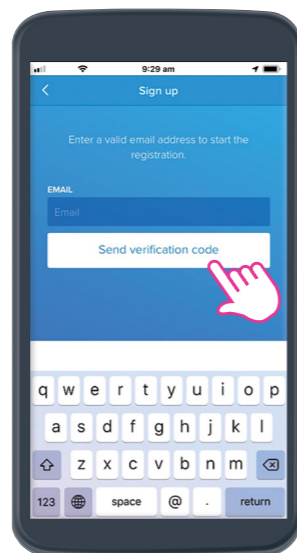

3. Enter your Email address and click "Send verification code".

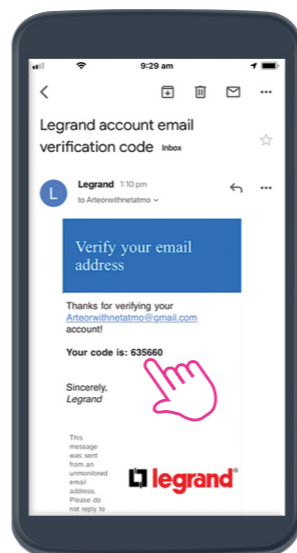

4. Go to your Email inbox, retrieve the **verification code**.

## 3 SETUP

Continued on page 5 >

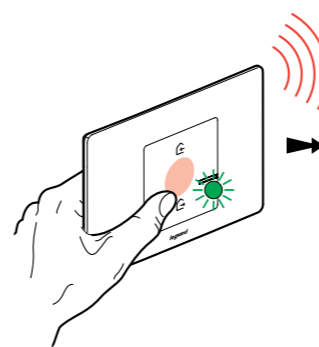

1. First, hold down the centre of the Wireless master switch until it briefly lights up green (This is the switch featuring two house icons).

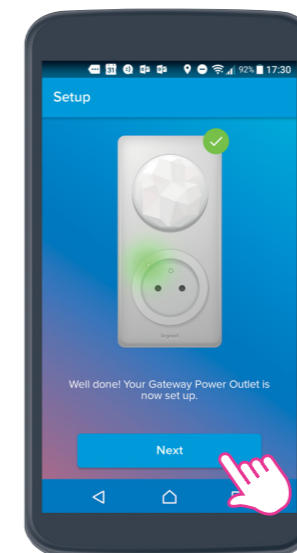

2. Click "Next".  
If you are using an iPhone: Set up the Apple HomeKit before going to step 3.

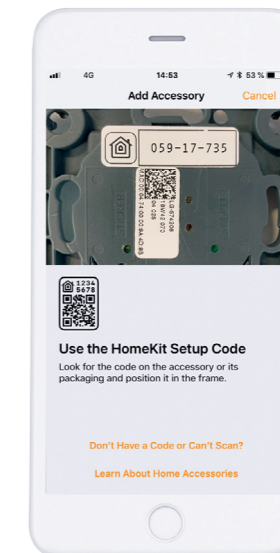

**For iPhone: scan the 8-digit code** at the back of the Wireless master switch (or user manual).

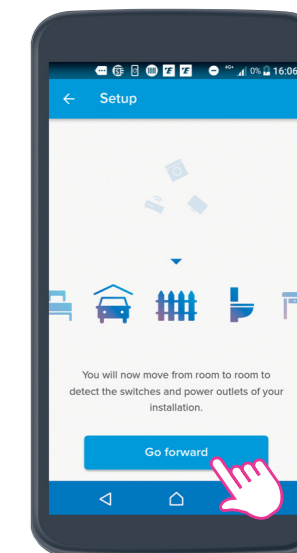

3. Click "Go forward" and move from room to room: the app will automatically detect any installed wired products.



# HOME + CONTROL APP:

## 3 SETUP (continued)

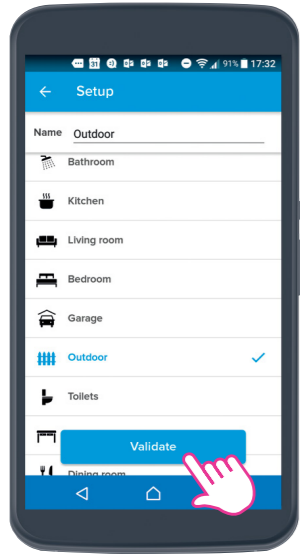

4. Select the type of room you are in and click **"Validate"**.

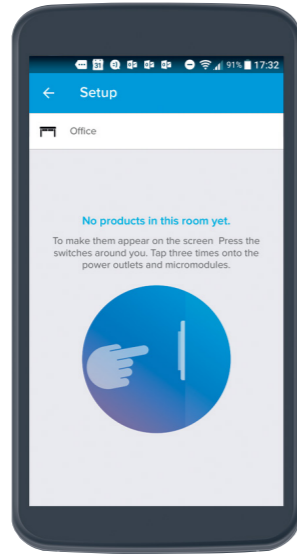

5. **Press** the switch or **tap three times** on the connected power outlets installed in the room.

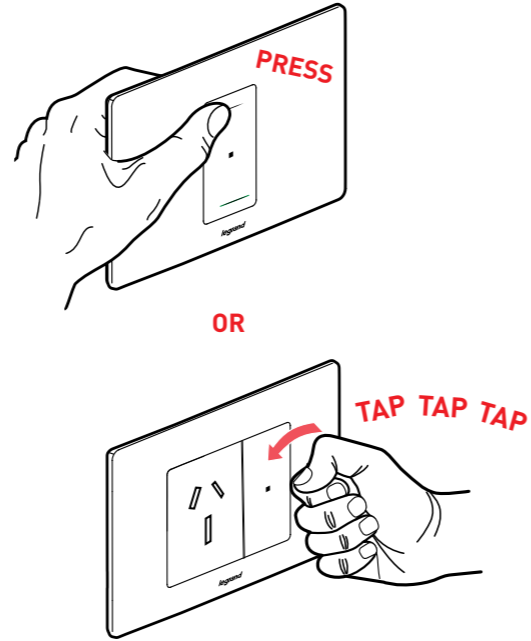

## 3 SETUP (continued)

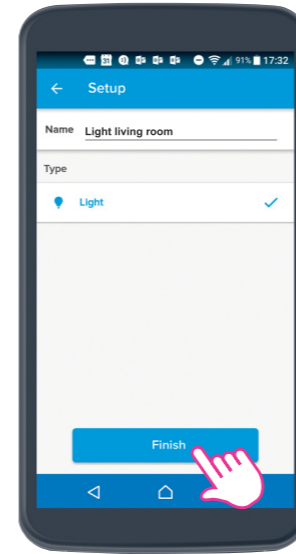

9. Once all products are named. Click **Finish**.

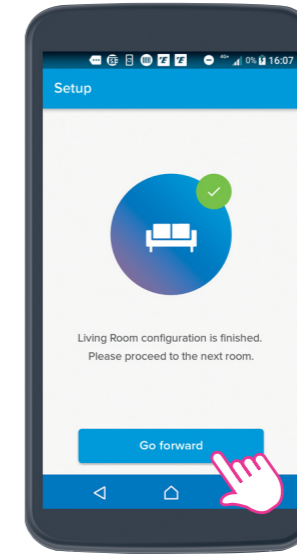

10. Click **Go forward** and move to the next room.

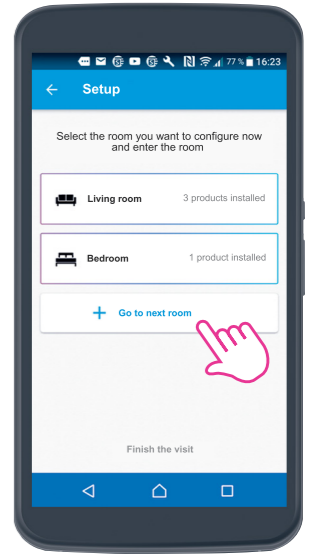

11. Click **Go to next room** and enter the room. Repeat **steps 4 to 10**.

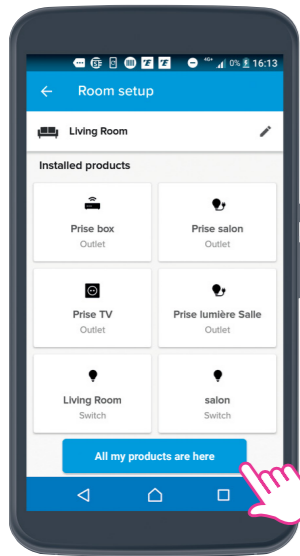

6. Click **"All my products are here"** once all the products have been detected.

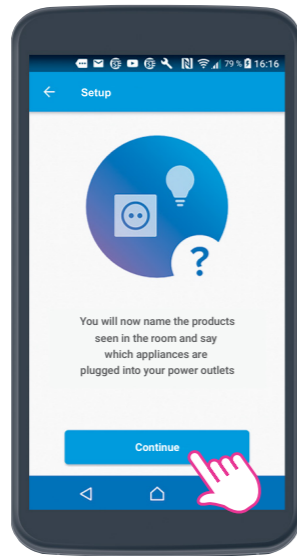

7. Click **"Continue"** to name products.

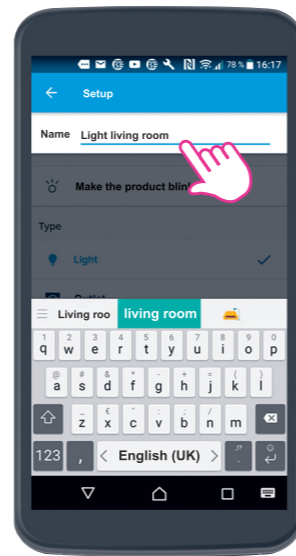

8. Name the products.

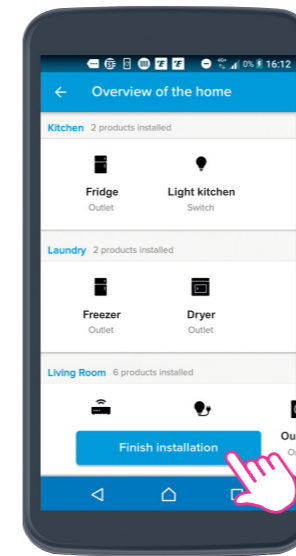

12. Click **"Finish the visit"**. Check all products are allocated to rooms, then click **"Finish installation"**.

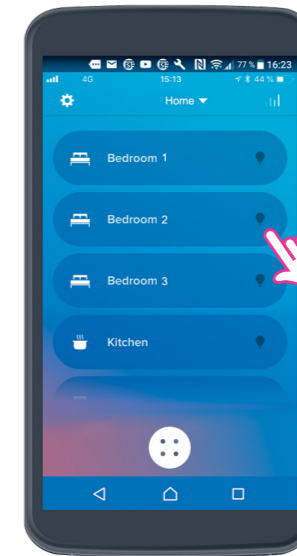

13. Once each room has been setup, a list of rooms will appear allowing you to control lights, electrical appliances, blinds and shutters.

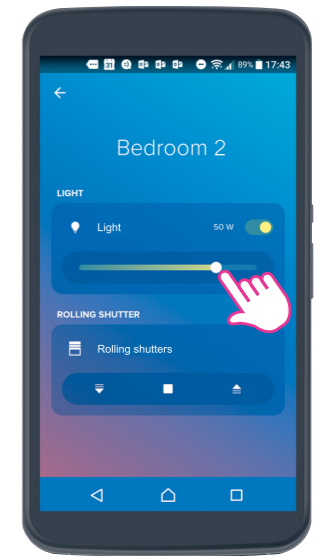

# HOME + CONTROL APP:

## 4 CHANGE THE LOCATION OF PRODUCTS ROOM BY ROOM

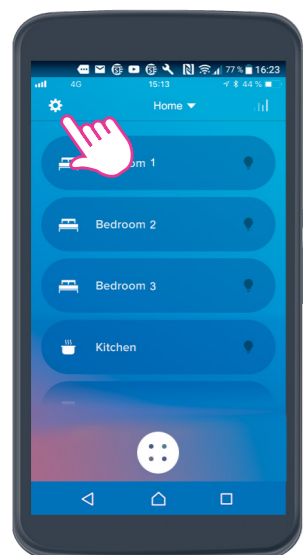

1. Click **Settings**.

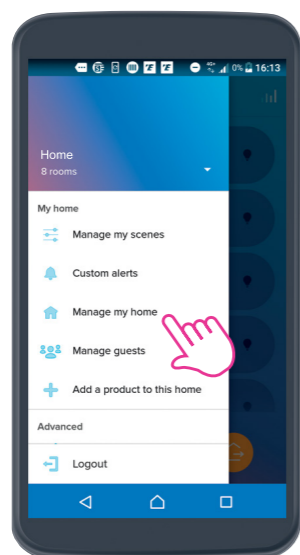

2. Select **"Manage my home"**. Now select the room which currently has the product you want to move.

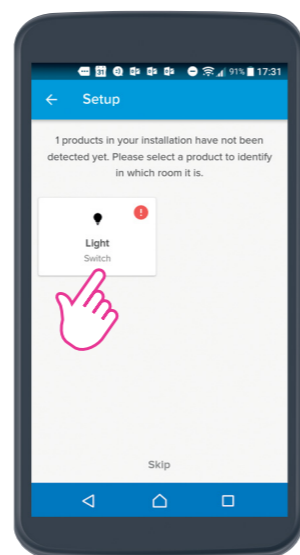

3. Select for example **"Light"**.

## 4 CHANGE THE LOCATION OF PRODUCTS ROOM BY ROOM (continued)

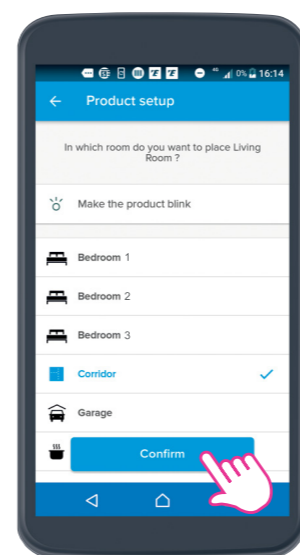

7. Click **"Confirm"** to confirm.

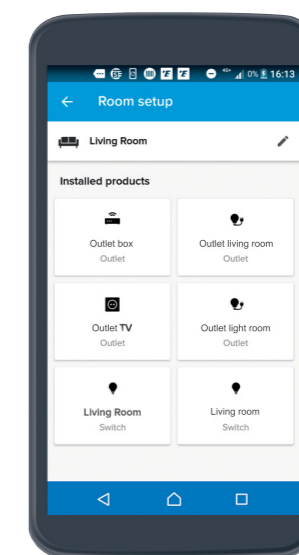

Continue in the same way to allocate each product to a room. Example: the **"Appliance"** and **"Light micromodule"** products have been assigned to **"Living room"**.  
NB: You can rename rooms and appliances using the same procedure if you wish.

## 5 SHARE YOUR INSTALLATION WITH OTHERS

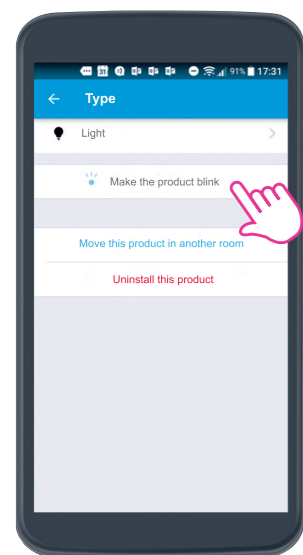

4. You can make the **"Light"** product blink so you can physically identify it.

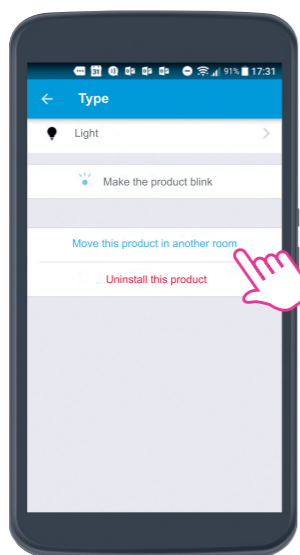

5. Click here to assign the **"Light"** product to a room.

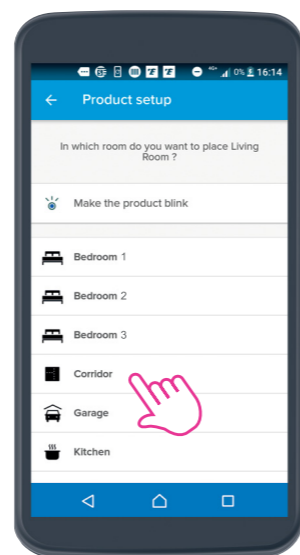

6. Position the **"Light"** product for example in **"Corridor"**.

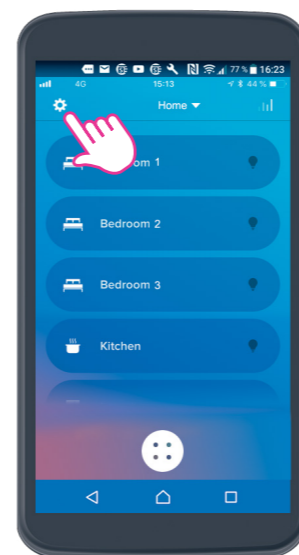

1. Click on **settings**.

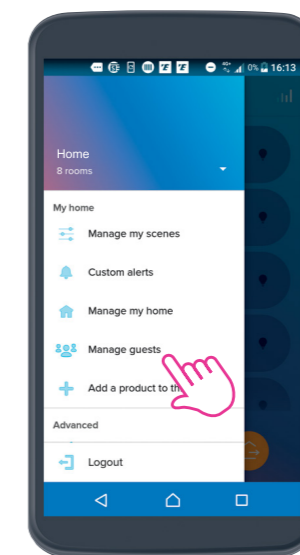

2. Click **"Manage guests"**.

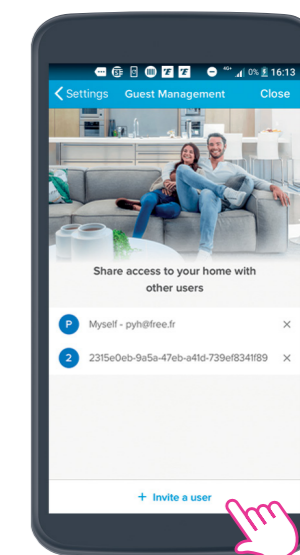

3. Click **"Invite a user"**. Enter the Email address of the person you want to share your smart installation with and send.



**Legrand Australia**

Building 4 Nexus Industry Park  
43-47 Lyn Pde Prestons NSW 2170  
1300 369 777

[www.legrand.com.au](http://www.legrand.com.au)

**Legrand New Zealand**

106-124 Target Road Glenfield  
Auckland 0627 New Zealand  
0800 476 009

[www.legrand.co.nz](http://www.legrand.co.nz)

Disclaimer: The information provided in this document is intended for informational purposes only. It has been prepared and reviewed with all reasonable care and is believed to be correct at the time of printing. Legrand Australia and New Zealand may also make improvements and/or changes to the products, pricing and/or programs described in this brochure at any time without notice.